

***Designed.
Engineered.
Remarkable
Value.***



Versatile Rear Tractor Blades

Models for Back Filling • Landscaping
• Snow Removal • Grading and Ditching



Distributed by: J. S. Woodhouse Co., Inc.
1314 Union St
West Springfield, MA 01089

Phone: 413-739-5607
Fax: 413-732-3786
email: info@jswoodhouse.com
website: www.jswoodhouse.com

Worksaver.



Worksaver® Rugged Rear Blades—**for the Tough Jobs!**

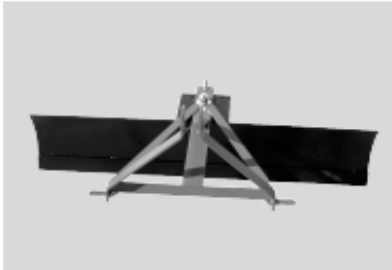

DC Series Blades

A value-priced line of blades designed for snow removal, lot and driveway grading, and light-duty landscaping. The simple but rugged A-frame design will provide years of dependable service.

Specifications

Tractor

Maximum hp 25
3-pt hitch Cat. 0/I

Moldboard

Width 4 ft & 5 ft
Height 13 in
Thickness 1/4 in
Cutting edge 3/8 x 3 in, welded

Adjustments

Angle 360°, 10 stops
Offset NA
Tilt NA

Weight

DC-4 114 lb
DC-5 126 lb

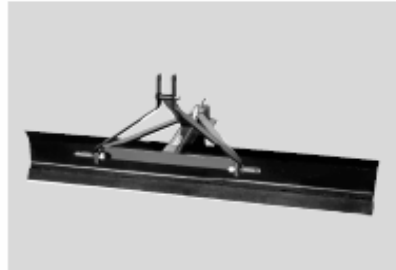

MCB Series Blade

Designed for the price-sensitive buyer requiring a 6-foot blade for snow removal, lot and driveway grading, and light landscaping. It is designed to work with tractors up to 35 hp.

Specifications

Tractor

Maximum hp 35
3-pt hitch Cat. I

Moldboard

Width 6 ft
Height 13 in
Thickness 1/4 in
Cutting edge 3/8 x 3 in, welded

Adjustments

Angle 360°, 6 stops
Offset NA
Tilt NA

Weight

MCB-6 165 lb



EB Series Blades

An economical line of blades designed for snow removal, lot and driveway grading, light-duty construction and landscaping. The A-frame and welded design ensure long service life. Models feature manual adjustment of offset and angle positions. Replaceable high carbon steel cutting edge is standard.

Specifications

Tractor

Maximum hp 35
3-pt hitch Cat. I

Moldboard

Width 6 ft & 7 ft
Height 13 in
Thickness 1/4 in
Cutting edge 3/8 x 3 in

high carbon steel,
single bevel, bolt on

Adjustments

Angle 360°, 8 stops
Offset 12 in R or 12 in L
Tilt NA

Weight

EB-6 190 lb
EB-7 206 lb

Options

Skid shoes

Distributed by: J. S. Woodhouse Co., Inc.
1314 Union St
West Springfield, MA 01089

Phone: 413-739-5607
Fax: 413-732-3786
email: info@jswoodhouse.com
website: www.jswoodhouse.com

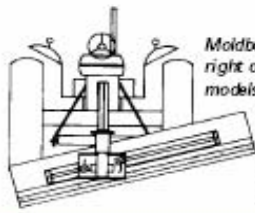

Moldboard tilts 20 degrees right or 20 degrees left on models UB-650-T, UB-750-T and UB-850-T; and 15 degrees right or 15 degrees left on models RB-880, XHB-1096 and XHB-1120

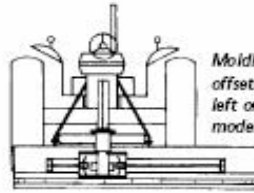

Moldboard offsets right or left on select models

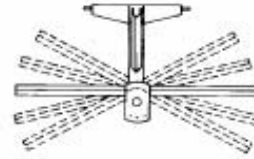

Forward and reverse angle adjustments vary by models

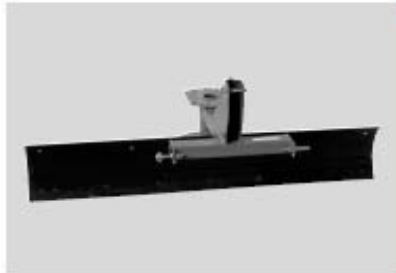

UB Series Blades

UB blades feature a sturdy all-welded steel frame with heavy 15-inch-high by 1/4-inch-thick moldboards. Heavy-duty tube main frame provides a long service life. These blades can rotate 360 degrees and offset up to 12 inches right or left. They are designed to work with tractors up to 50 hp. Reversible high carbon steel cutting edge is standard.

Specifications

Tractor
 Maximum hp 50
 3-pt hitch Cat. I
 Moldboard
 Width 6 ft, 7 ft & 8 ft
 Height 15 in
 Thickness 1/4 in
 Cutting edge 1/2 x 6 in
 high carbon steel,
 reversible, bolt on

Adjustments

Angle 360°, 10 stops
 Offset 12 in R or 12 in L
 Tilt 20° R or 20° L
 models UB-650T, UB-750T
 & UB-850T only

Weight

UB-645 275 lb
 UB-745 300 lb
 UB-650-T 306 lb
 UB-750-T 331 lb
 UB-850-T 370 lb

Options

Skid shoes
 End plates

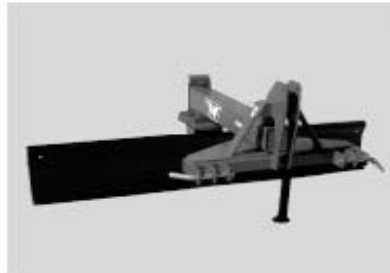

RB Series Blade

The RB blade is designed for heavy-duty work with tractors up to 80 hp. A heavy-duty 6-inch by 6-inch main beam and reinforced blade add extra strength to the 1/4-inch-thick moldboard. Angle, tilt, and offset (swing arm) are manually controlled. Reversible high carbon steel cutting edge is standard. A parking stand is provided for easy storage and convenient hook up.

Specifications

Tractor
 Maximum hp 80
 3-pt hitch Cat. I/II
 Moldboard
 Width 8 ft
 Height 15 in
 Thickness 1/4 in
 Cutting edge 1/2 x 6 in
 high carbon steel,
 reversible, bolt on

Adjustments

Angle 360°, 10 stops
 Offset (swing) 30 in R or 30 in L
 Tilt 15° R or 15° L

Weight

RB-880 668 lb

Options

Skid shoes
 End plates

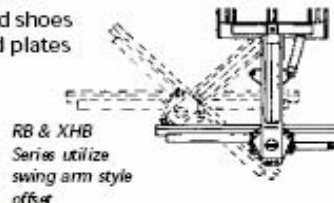

RB & XHB Series utilize swing arm style offset



XHB Series Blades

The XHB blades are designed for heavy-duty farm and construction use with tractors up to 120 hp (depending upon model). The 19-1/2 inch-high by 5/16-inch-thick moldboard is designed for extra strength. XHB blades can be equipped with three hydraulic cylinders for full hydraulic control or with a combination of hydraulic and manually operated functions. A retractable heavy-duty parking stand is standard. The blade is equipped with a reversible high carbon steel cutting edge.

Specifications

Tractor
 Maximum hp 120 for 8-ft blade
 110 for 10-ft blade
 3-pt hitch Cat. II
 Moldboard
 Width 8 ft & 10 ft
 Height 19-1/2 in
 Thickness 5/16 in
 Cutting edge 1/2 x 6 in
 high carbon steel,
 reversible, bolt on

Adjustments

Angle 360°
 Offset (swing) 30 in R or 30 in L
 Tilt 15° R or 15° L

Weight

XHB-1096 1,121 lb
 XHB-1120 1,227 lb

Options

Skid shoes
 Hydraulic cylinder kit
 Crossover relief valve kit
 Ratchet jack

Work saver® Rear Blade Options

Skid Shoes for Rear Blades

- Remove Snow
- Level Gravel
- Clean Feedlots or Barns
- Reduce Blade Damage
- Increase Blade Life
- Prevent Gouging

Snow removal and farm cleanup have fewer surprises when skid shoes are attached to the rear blade. No more guessing blade height each time you lower the blade. Skid shoes provide adjustable clearance to travel over uneven surfaces that can damage the blade. They also help prevent damage to the blade when used in cleaning level surfaces, simplifying operations on driveways, barn floors and feedlots.

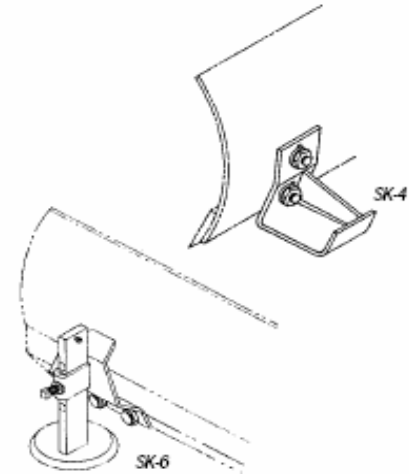

Model	Number	Description	Weight
SK-4	320035	Skid Shoes for EB Series Blades	9 lb
SK-6	346630	Skid Shoes for UB & RB Series Blades	24 lb
SK-6	348050	Skid Shoes for XHB Series Blades	28 lb

End Plates for Rear Blades

Material handling is easier when you install rear blade end plates. Quickly gather and efficiently move dirt, gravel, slurry or manure to more desirable locations.

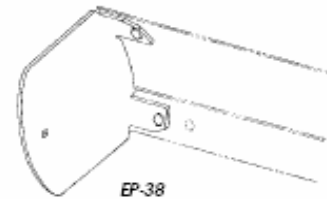

Model	Number	Description	Weight
EP-38	346620	End Plates for UB & RB Series Blades	44 lb

On the front cover: Work saver UB Series Blade



WORKSAVER, INC. has a corporate policy of continuous product improvement and development; therefore specifications are subject to change without any advance notice. WORKSAVER, INC. is not responsible for differences between specifications or illustrations contained in this publication and the actual equipment.

**Designed.
Engineered.
Remarkable
Value.**

Distributed by: J. S. Woodhouse Co., Inc.
1314 Union St
West Springfield, MA 01089

Phone: 413-739-5607
Fax: 413-732-3786
email: info@jswoodhouse.com
website: www.jswoodhouse.com